

BEAVERS SPORTS LODGE CHILDREN'S & ADULT EDUCATION CENTRE



The Football Foundation, working directly with Beavers Community Primary School and Lewis Designs, raised over a million pounds to fund a much-needed regeneration project in Hounslow. The new children's and adult education centre and sports lodge was designed to be a versatile space, offering a variety of uses for Beavers school and the local community.

"We have fully realised our vision of becoming the first full-service extended primary school in Hounslow; Lewis Designs were integral to this process."

*Dee Scott, Headteacher
Beavers Community Primary School*

The lodge is split into two main buildings, linked by a central entrance area and café. There is a large adult education centre and nursery, three football pitches and two floodlit all-weather multi-sport areas, all designed to be part of the new full-service extended primary school.

Being so close to Heathrow Airport's flight path was always a major concern when planning the new centre, due to noise pollution. With the windows closed to keep out aircraft noise, the building still needed to be fully-functional, so the climate is controlled by a warm air/cool air system throughout. In addition, the roofing is super-insulated, which has the benefit of reducing heating costs too.

In spite of a tight budget, Lewis Designs are particularly proud of the exposed structure of the building's vaulted ceilings. These begin from internal central columns, from which long timber beams extend through to the outside of the building, finishing externally as a recognisable feature of the building. This design keeps rooms free from internal supports, offering large internal spaces with a great sense of openness and freedom.

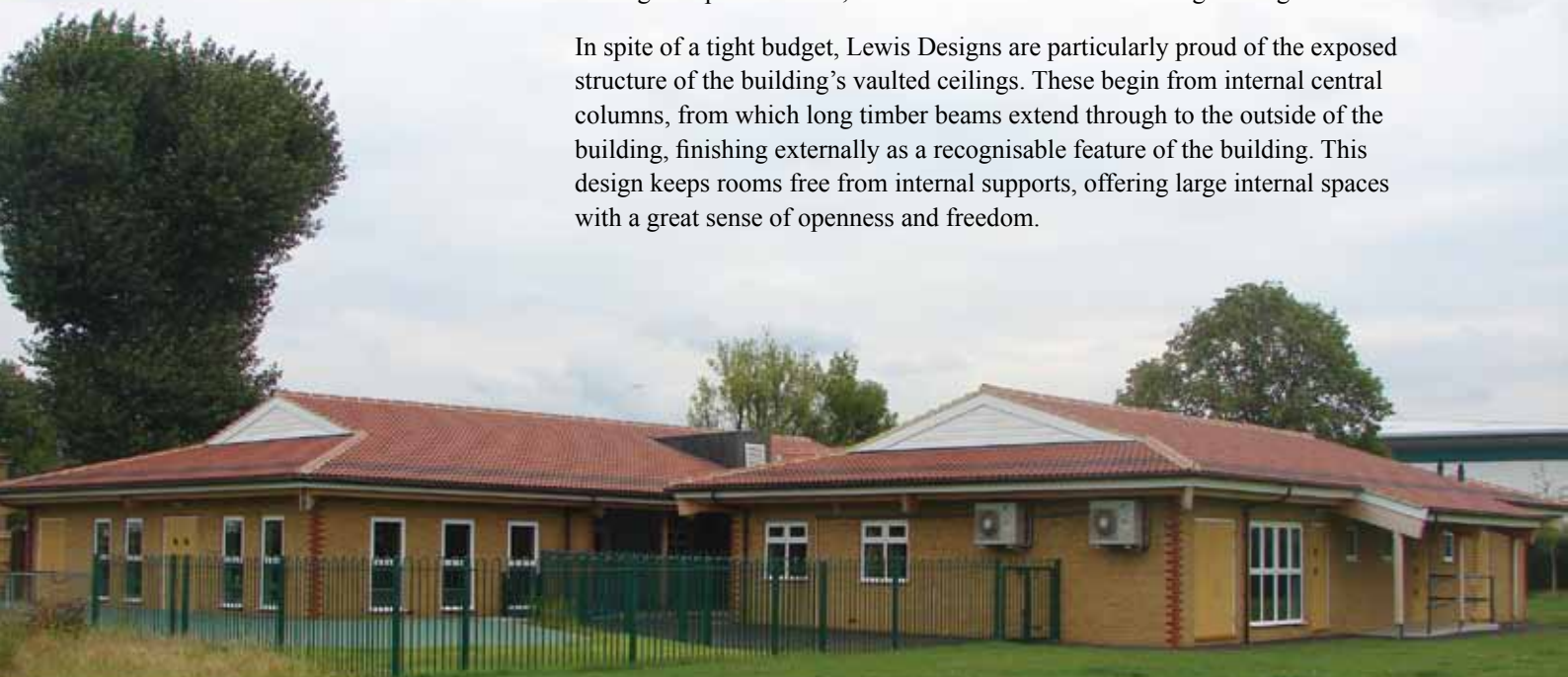

LEWIS DESIGNS ARCHITECTS

CHATSWORTH

INFANT & NURSERY SCHOOL

The new nursery, designed as an annex to the existing school, was conceived by Lewis Designs with the concept of combining indoor and outdoor play, all year round. The classrooms have their own directly-accessible covered outdoor areas, in line with modern teaching practises. Lewis Designs worked with a strict budget and tight timescales on this project, liaising closely with the local education authority to ensure a very successful outcome.



MODERNISATION

Over the years, Lewis Designs has worked with schools who simply require small unused areas to be updated. From our experience, we believe there are many ways in which often-overlooked space can be utilised. From creating new toilet blocks to converting storage rooms into libraries or group rooms, Lewis Designs can suggest improvements for any forward-thinking school.

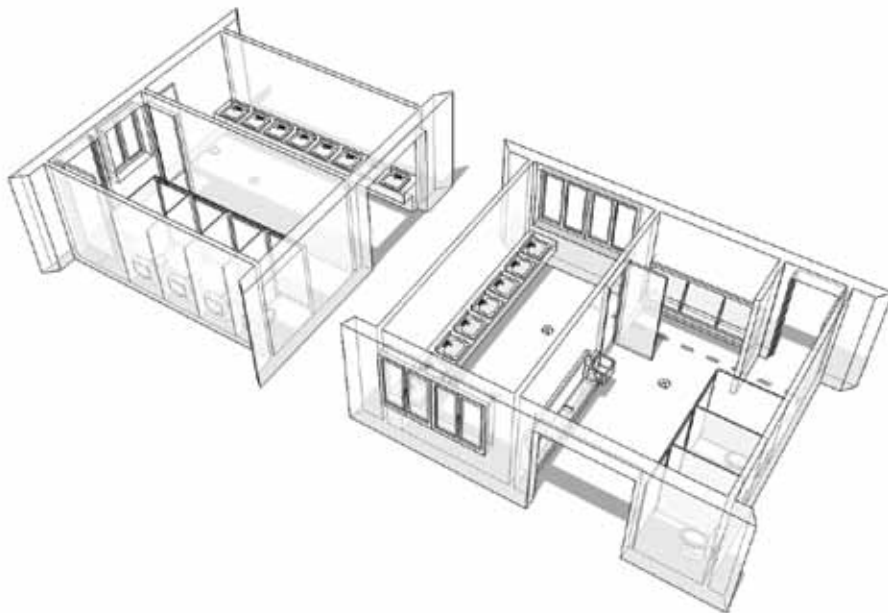

LEWIS DESIGNS ARCHITECTS

6 St. Lawrence Lane
Ashburton
Devon
TQ13 7DD
T: 01364 652768



WORPLE PRIMARY SCHOOL

Lewis Designs has worked on a number of projects with Worples Primary School, helping the headteacher, staff and governors create a modern school with a welcome, happy environment.

A phased scheme of work is underway, which started with improvements to flooring throughout. Infant classrooms now have defined areas that very young children can identify with. In addition, utility rooms have been converted into remedial classes, and all the school's toilets will soon be revamped with bright, modern materials.

It's not just about the kids – the staff room has a new kitchen designed to cater for teachers' typical short lunch breaks, while an adjoining work area with internet access enables marking or planning time, away from the pupils. Elsewhere in the school, the administration area has been greatly improved. Each phase of the project was successfully completed within a tight timescale.

For further information about our work, please email us at info@lewisdesigns.co.uk or visit our website.

www.lewisdesigns.co.uk